



DUBLIN PORT GREENWAY

Progress Update August 2022

Greenway Route And Connections



Viewing Points

Architectural Design Update

Viewing Point 1



Viewing Point 1



Viewing Point 1



Viewing Point 2



Viewing Point 2



Viewing Point 2



Viewing Point 3

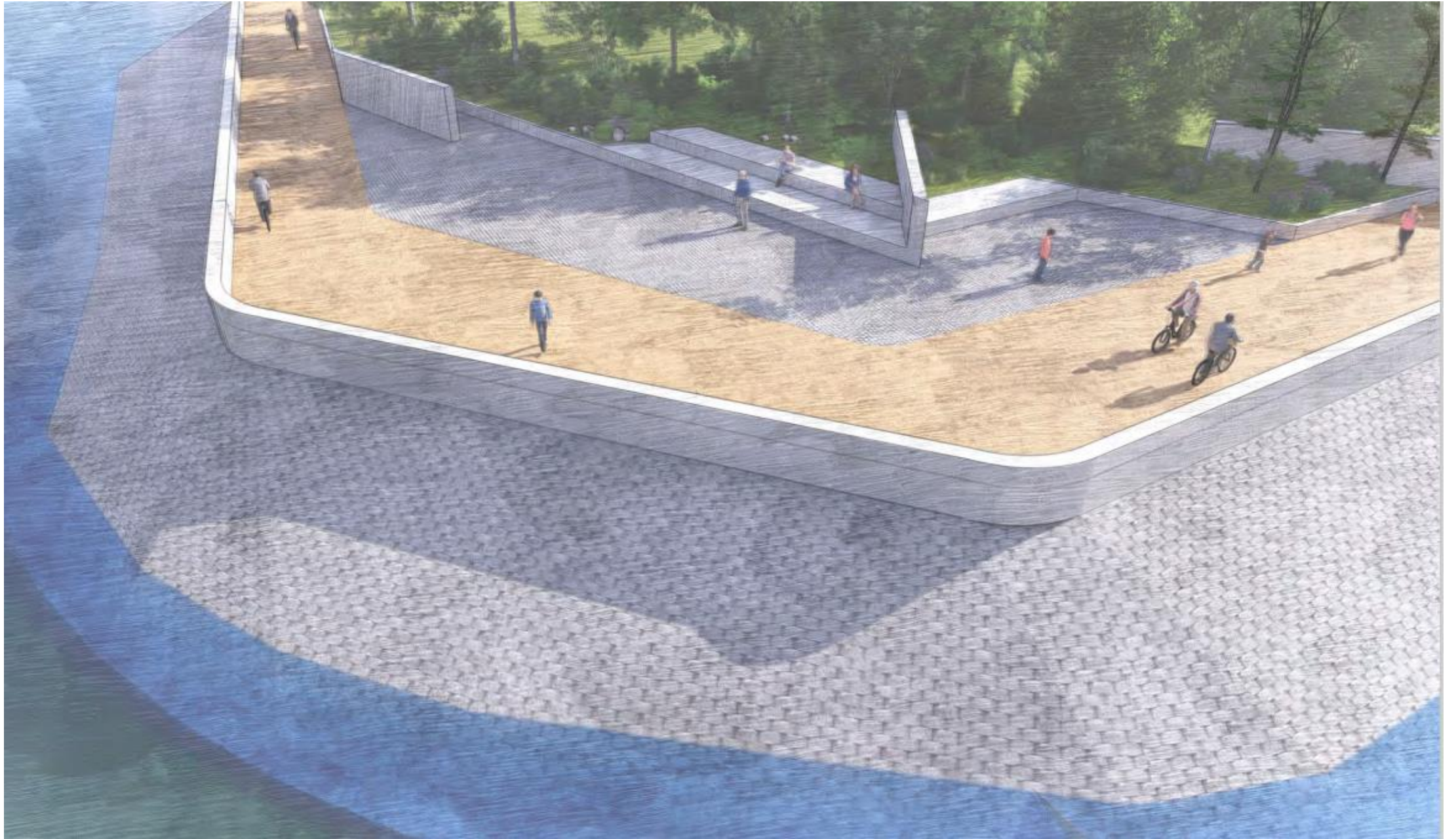

Viewing Point 3



Lighting Design

Tolka Square Entry Point Lighting

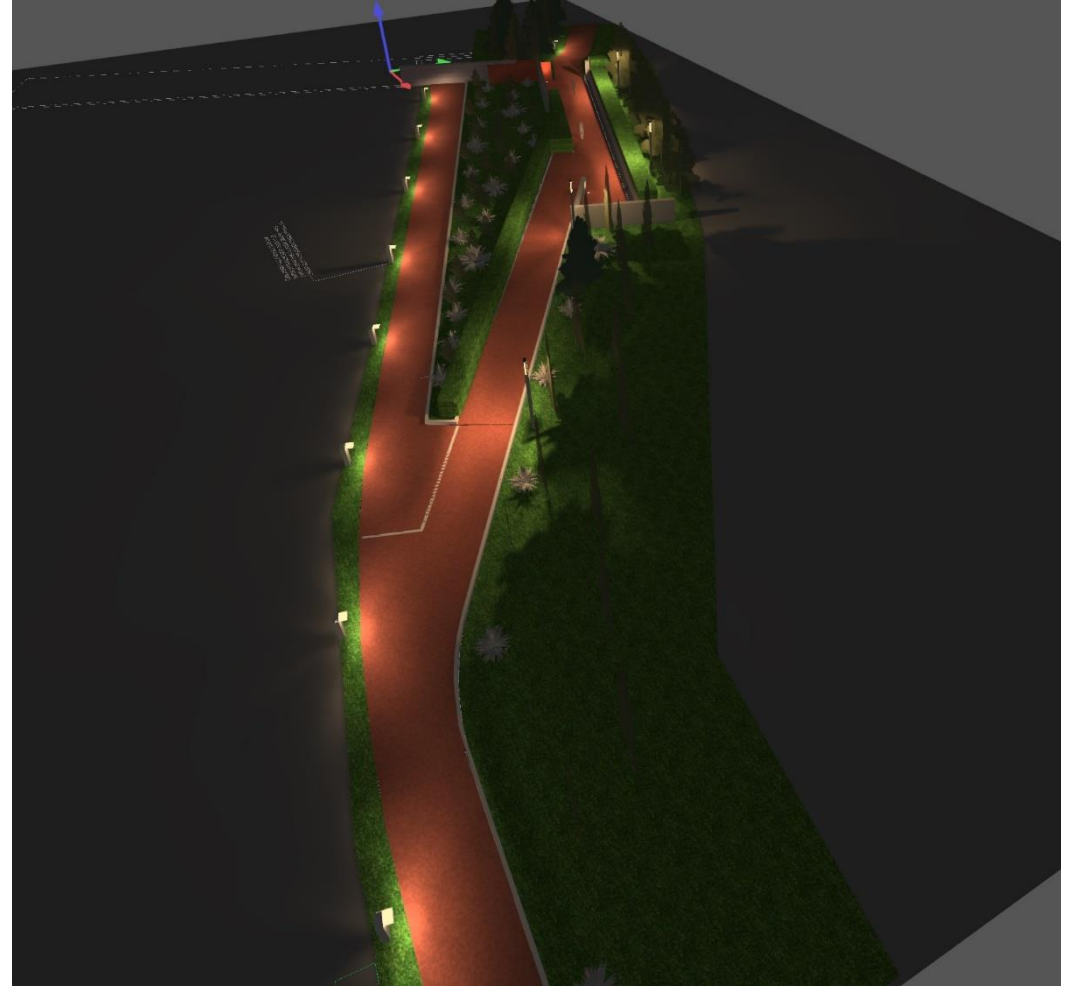
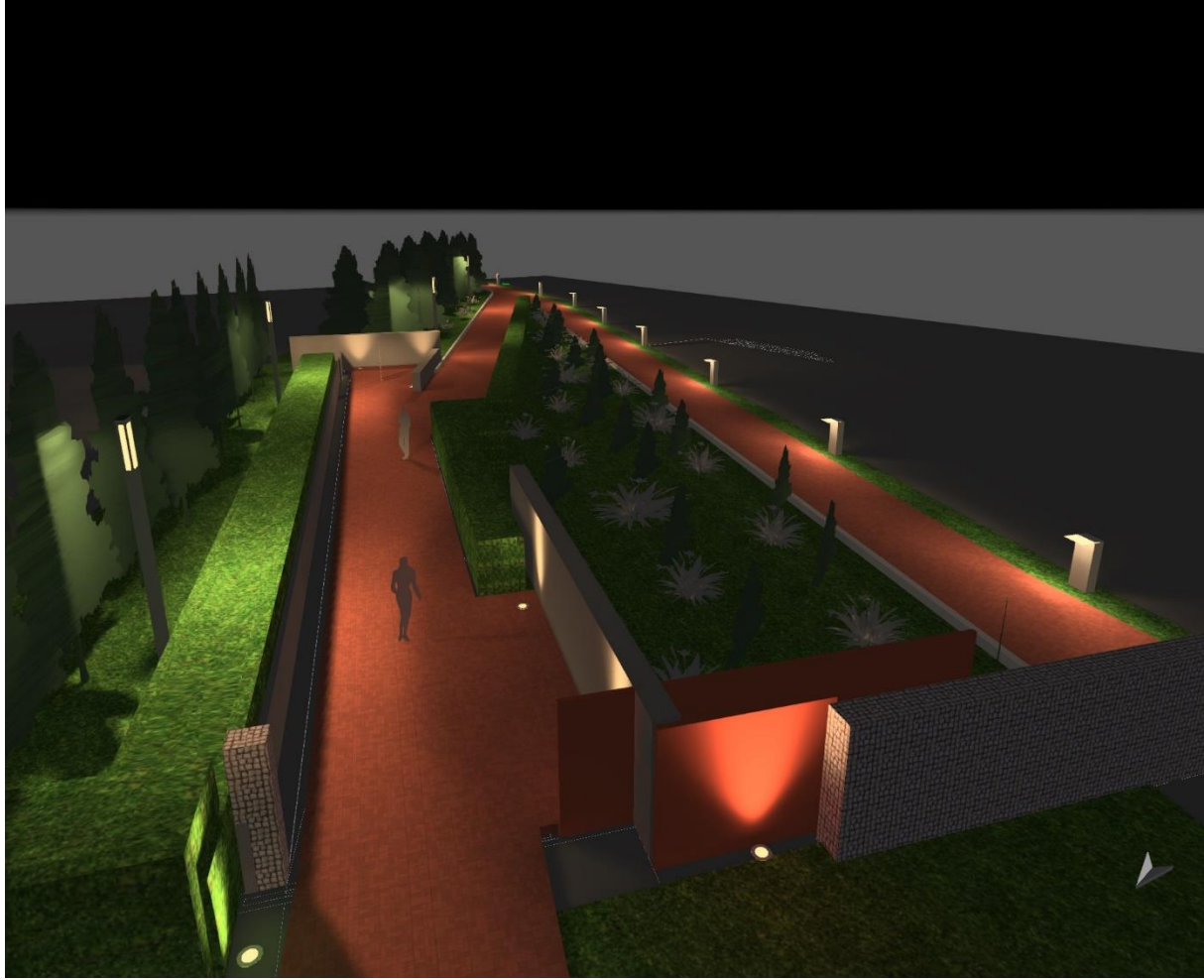

Linear Route Lighting

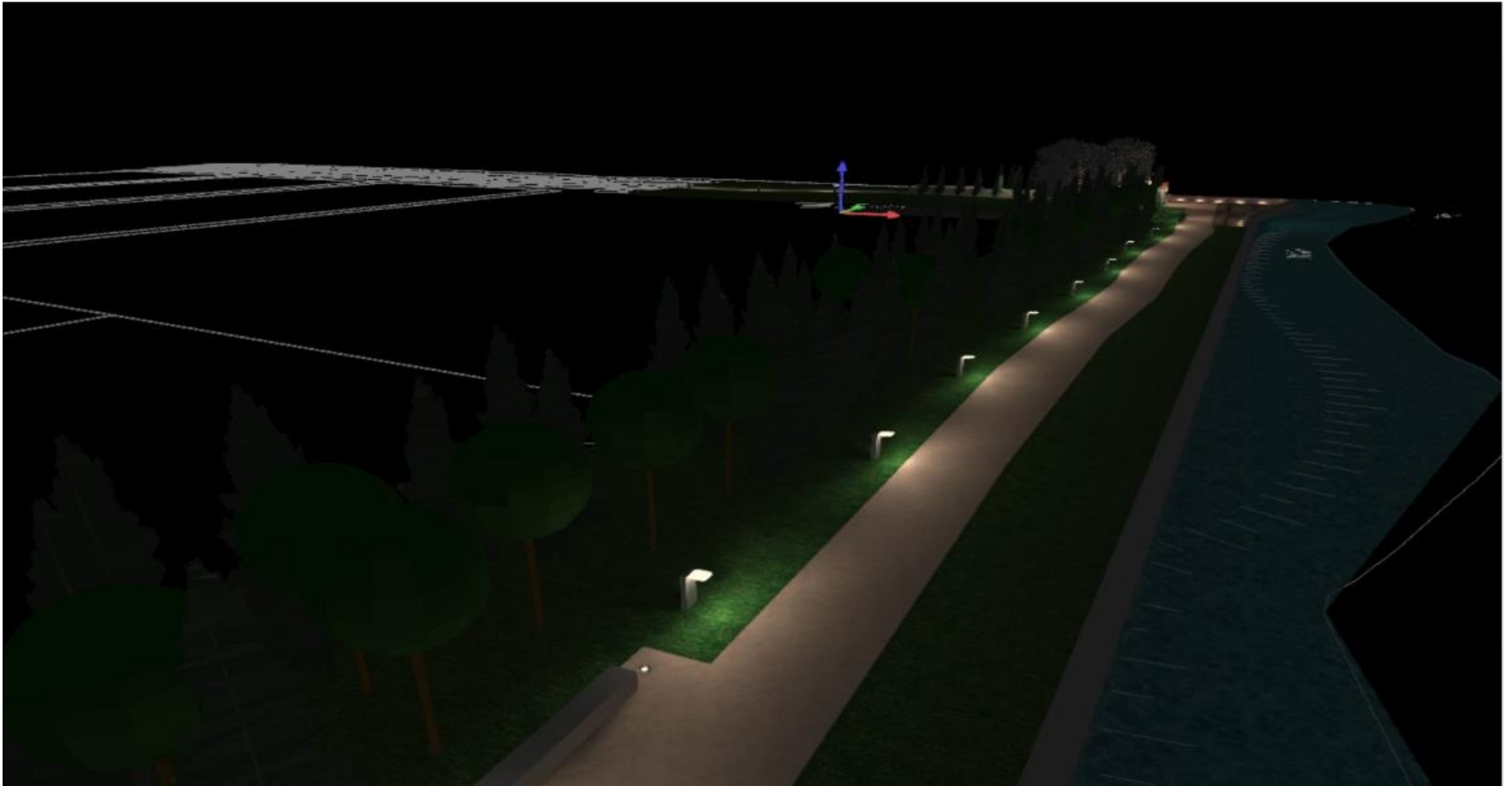

Viewing Point 1 Lighting



Viewing Point 2 Lighting

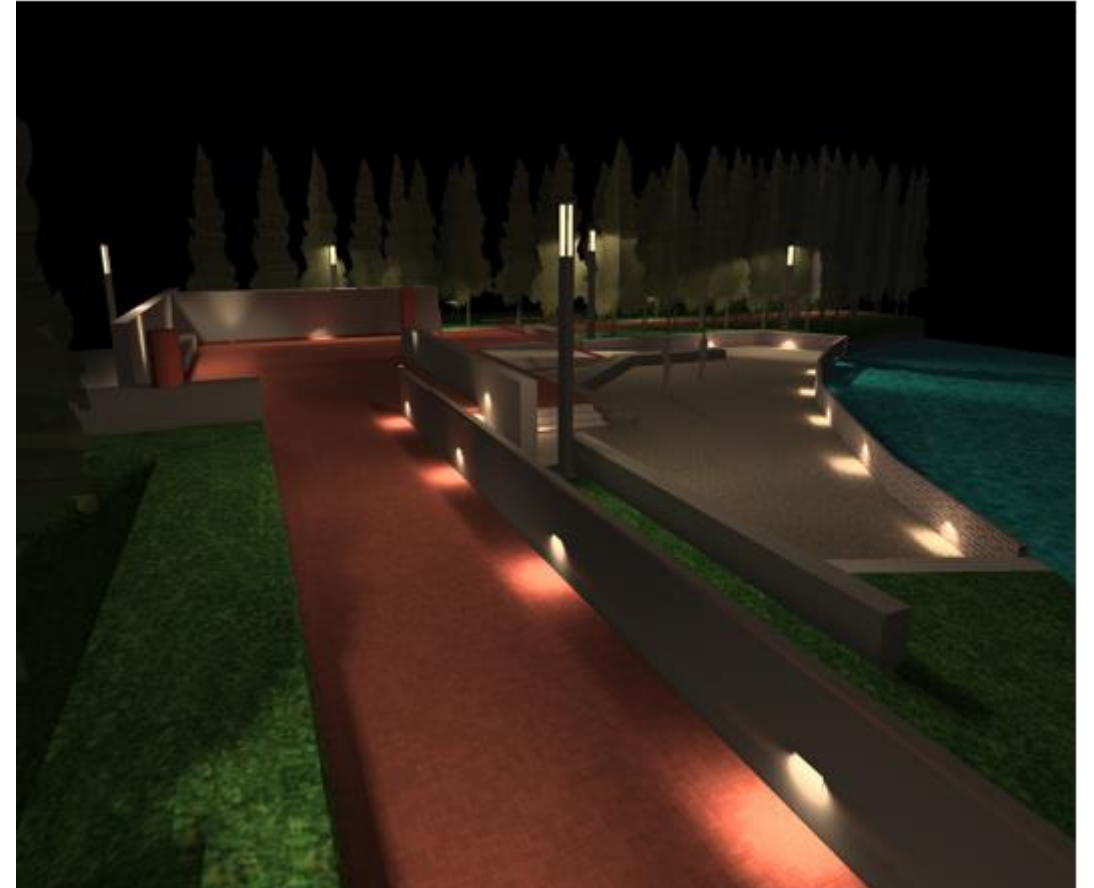

Linear Section Lighting

Viewing Point 3 Lighting

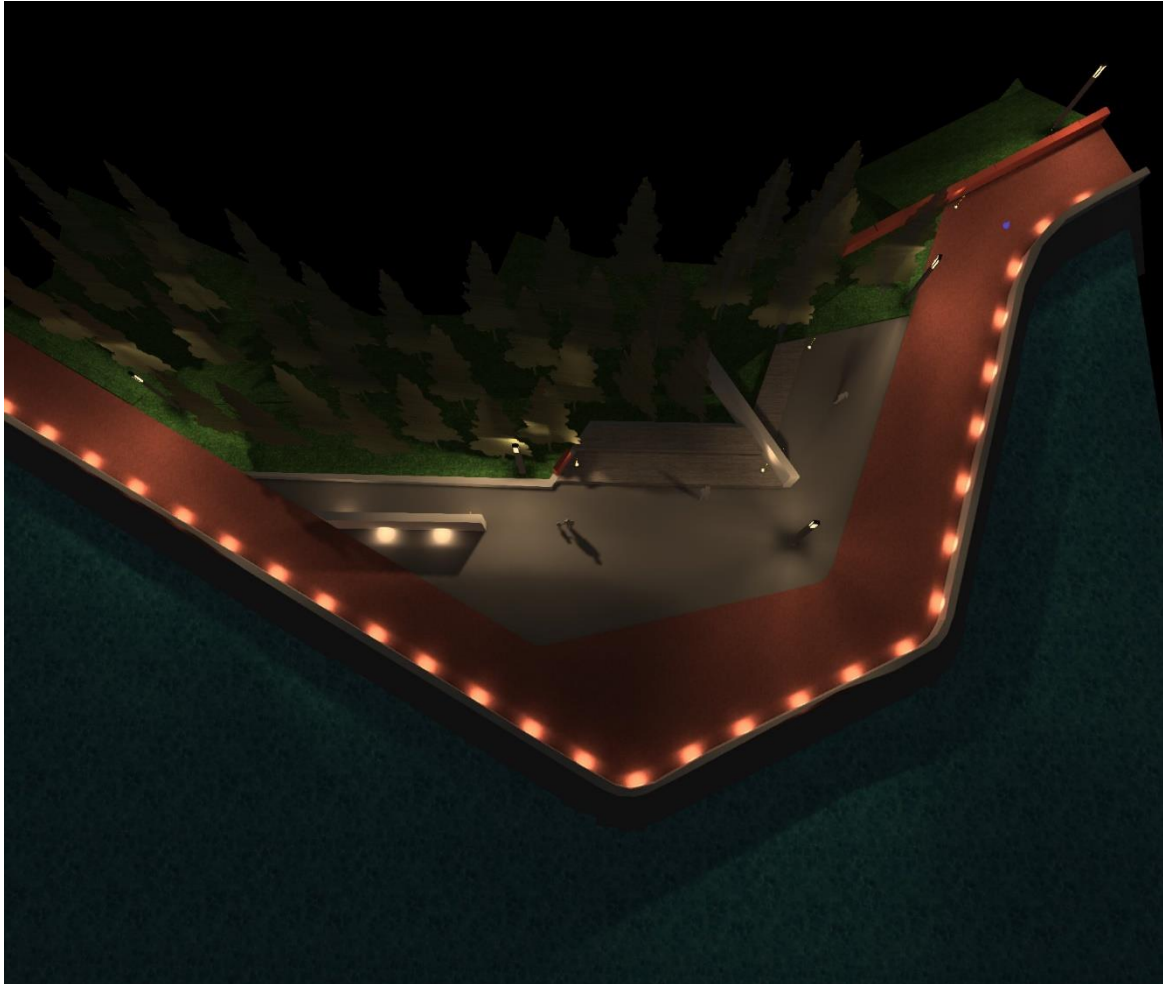

Lighting Types



Project Delivery Update

- Viewing Points Architectural and Engineering design complete.
- Hard Landscaping tender being prepared for issue. Construction works expected to commence Q1 2023.
- Soft Landscaping tender ready for issue. Planting expected to commence Q4 2022.
- Lighting & CCTV design nearing completion.